

VISION OUTSIDE



Vision Outside - the patented industry leading latching system for high quality applications, especially developed for enclosures that require absolute protection against the elements.

The system has a built-in 3 mm compression function and the attention to detail and dedicated craftsmanship, from metal casting to powder coating, ensures that Vision Outside is the finest latching system available in the market. When you need to protect valuable electronics from a harsh environment, this is the system for you.

The control mechanism is delivered assembled with flat rod and latching points are ordered separately.



MATERIAL

Control mechanism: Zinc die cast, zinc plated, special surface treatment (passes 30 day salt-spray test according to ISO 9227, equivalent to ASTM B 117) or glass fibre reinforced polyamide (PA6GF30)

Rod: Steel, zinc plated or stainless steel 316

RELATED PRODUCTS

Handles: 1-004.04, 1-004.05, 1-002.02, 1-005.10, 1-006.50, 1-002.01, 6-010, 1-002.03, 1-006.01, 1-006.03, 1-007, 1-002.08

Rods: 1-008.05/13

Needed components for a complete system:
1-008.05

Use the Index Code at industrilas.com

TECHNICAL INFORMATION

- Multiple latching points for perfect latching and compression in tall applications.
- System with more than four latching points available upon request.
- Control mechanism comes complete assembled with flat rod. Latching points ordered separately.

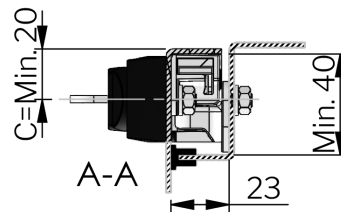
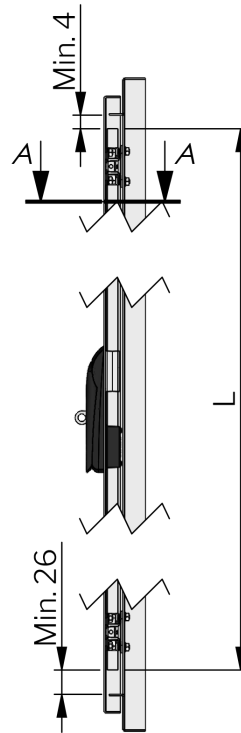

Make your selections in each column to create your article number (AAAA-BBBB-CCCC)

| AAAA | Material rod | Material control mechanism | BBBB | Rod system | CCCC | L in mm | L1 in mm | L2 in mm |
|------|--------------------|----------------------------|------|--------------------------------|------|---------|----------|----------|
| 1321 | Steel, zinc plated | Zinc, zinc plated | 1000 | Vision Inside + Vision Outside | 0500 | 500 | 200 | - |
| 1390 | SS 316 | Zinc, Delta seal | | | 0900 | 700 | 300 | - |
| 1350 | Steel, zinc plated | PA6GF30 | | | 1200 | 1500 | 400 | - |
| 1395 | SS 316 | PA6GF30 | | | 982 | 982 | 300 | 700 |
| | | | | | 1700 | 1700 | 300 | 800 |

